

Profil 1.

Profil 2.

1.

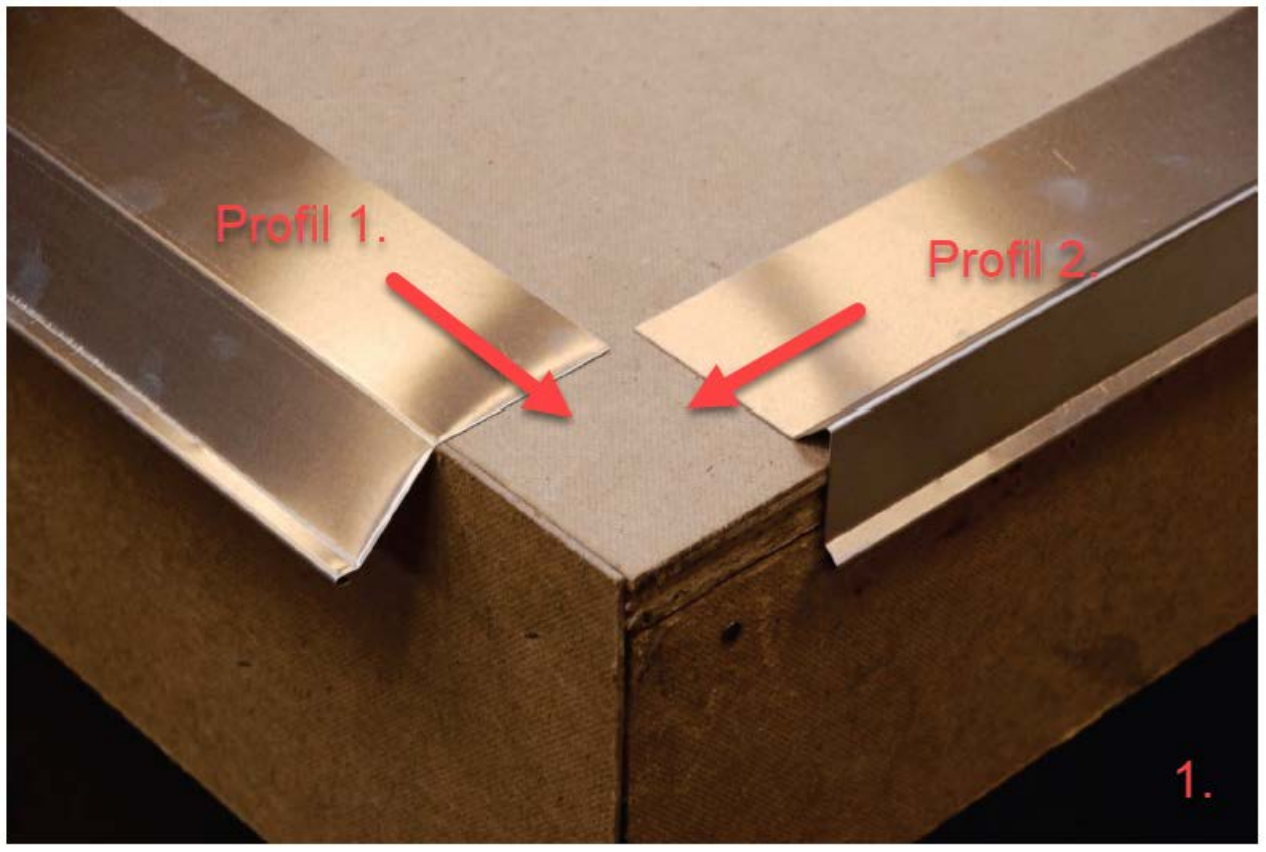

Profil 1.



45



2.



90
grader

profil 1.



Profil 1.

5.

Profil 1.



Profil 1. Færdig.



A close-up photograph of a person's hand holding a metal profile. The profile is a dark, rectangular metal strip. A yellow pencil with a red eraser is positioned to the left of the profile. A small, rectangular metal tag is attached to the bottom edge of the profile, with the number '45' written on it in red. The background is a dark, textured surface.

Profil 2.

45

8.

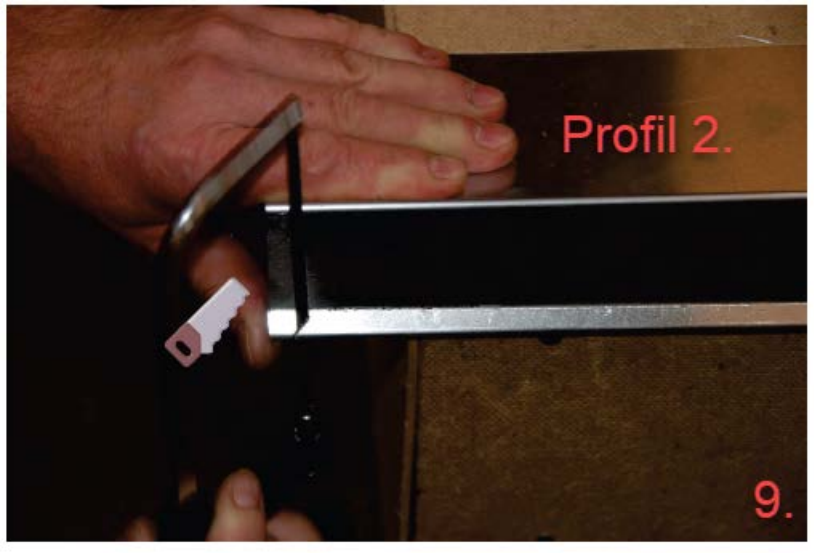
A close-up photograph showing a person's hand holding a long, thin metal profile. The profile has a rectangular slot cut into it. A key with a white, serrated bit and a red base is being inserted into this slot. The background is a dark, textured surface, possibly a door or a panel. The text "Profil 2." is overlaid in red on the right side of the image.

Profil 2.

9.

A close-up photograph showing a person's hands working on a wall. The person is using a utility knife with a yellow and black handle to cut a silver metal profile. The profile is being held in place by another hand. The wall is made of a light-colored, textured material, possibly plaster or drywall. The number '10' is visible in the bottom right corner of the image.

Profil 2.

10

Profil 2.



45 grader

11.

Profil 2.

12.

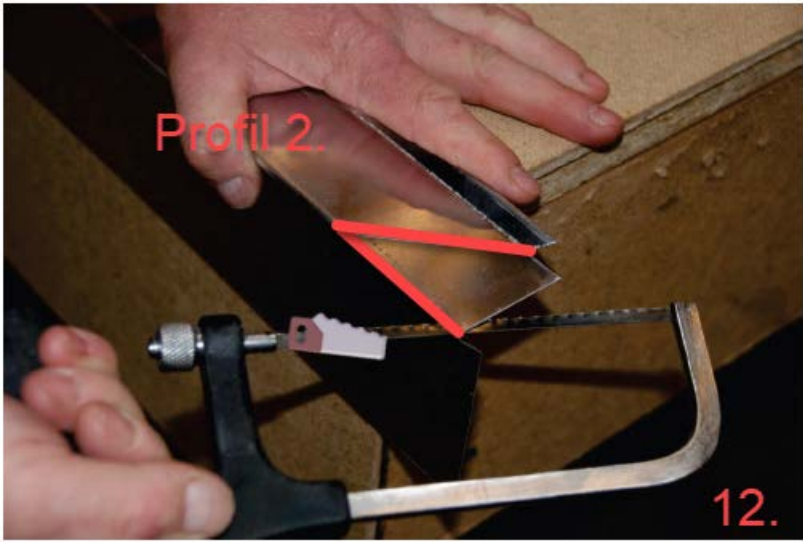

Profil 2.



13.



Kant af
tagfod

Profil 2.

14.



Profil 2.

15.



Profil 2.



16.



Profil 2.

17.



Bores for
2 nitter

Profil 2.

18.



2 nitter

Profil 2.

19.

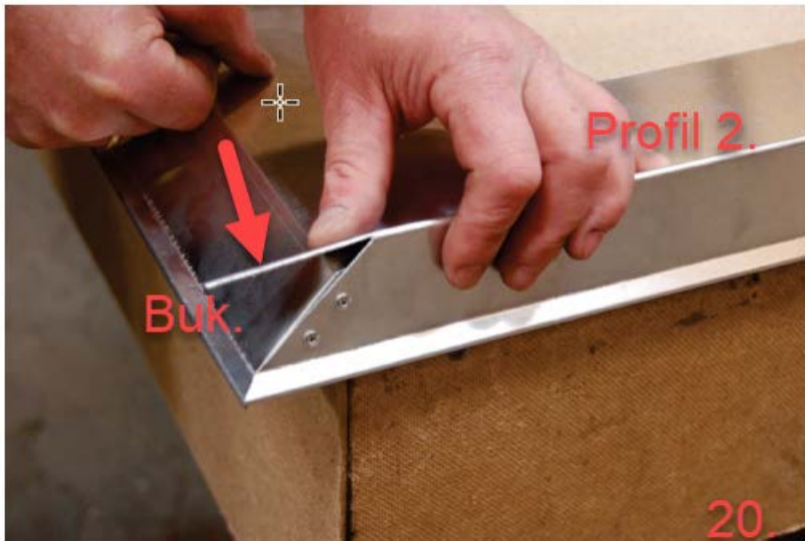

Profil 2.

Buk.

20.

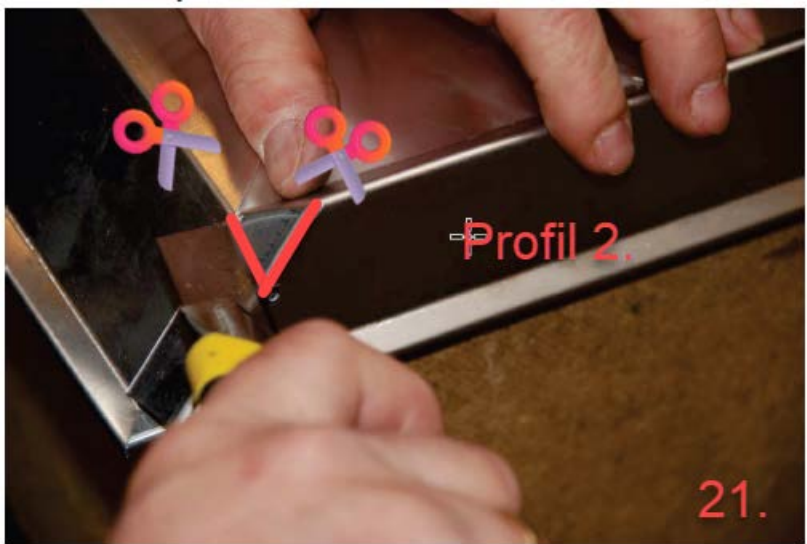

Profil 2.

21.

A close-up photograph of a metal corner joint. Two profiles, labeled 'Profil 1' and 'Profil 2', are joined together. The joint is finished, as indicated by the text 'Færdig'. The profiles are made of a dark, possibly anodized, metal. The corner is reinforced with a triangular metal piece. The background is a dark, textured surface.

Profil 1 - profil 2.
Færdig

22.